

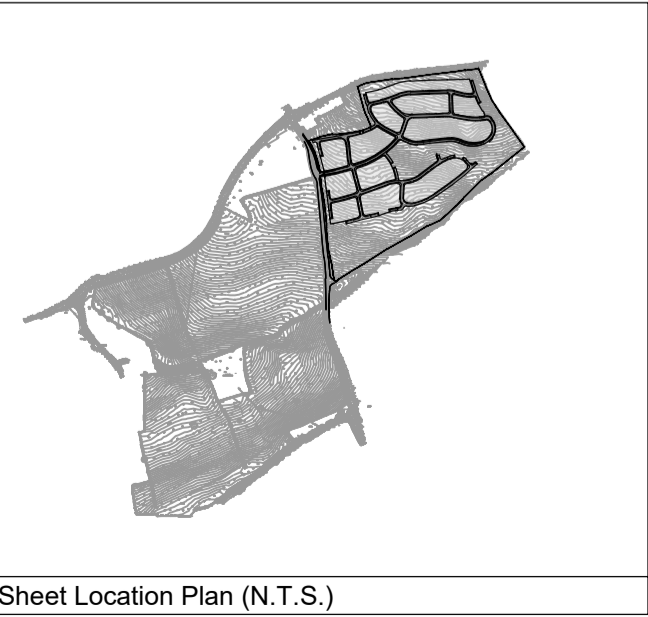

- LEGEND**
- DEVELOPMENT SITE BOUNDARY
 - EXISTING ELECTRICITY (UNDERGROUND)
 - PROPOSED ELECTRICITY SERVICES
CONSTRUCTED AS PART OF SPINE ROAD
 - POTENTIAL FUTURE SERVICES DISTRIBUTION

- NOTES:**
- ALL INFORMATION IS FOR ILLUSTRATION PURPOSES ONLY.
 - OFF SITE REINFORCEMENT REQUIREMENTS TO BE CONFIRMED.
 - SERVICES AVAILABLE LOCALLY/CONNECTIONS IN BOLSOVER ROAD TO BE CONFIRMED.
 - DEVELOPMENT LOADINGS ARE TO BE CONFIRMED.
 - SERVICES DISTRIBUTION SIZES/CAPACITY TO BE CONFIRMED.
 - SUB-STATION LOCATION AND SIZE TO BE CONFIRMED.

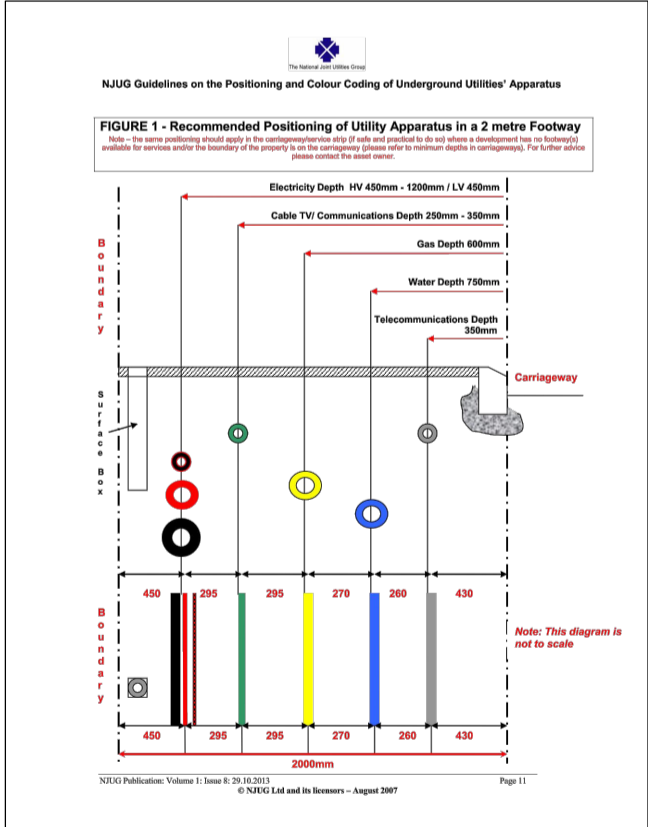

SCALE 1:1000 20 10 0 20 40 60 80 100m

MASTER PLAN UPDATED	22-09-2021	P03
	BMS MB	MB
DRAWING AMENDED TO SUIT CLIENT COMMENTS	20-09-2021	P02
	SNC MB	MB
DRAWING AMENDED TO SUIT CLIENT COMMENTS	17-09-2021	P01
	SNC MB	MB
FIRST ISSUE	09-09-2021	P0
	SNC JR	MB
Issue Details	Dwn Chd App'd	
Client	PRELIMINARY	

DEVONSHIRE PROPERTIES

MASTIN MOOR

Dwg Title
**PROPOSED
ELECTRICAL LAYOUT PLAN
PHASE 1 & 2**

Dwg No.	22188-IML-00-XX-DR-C-0502	Revision	P03
Scale	1:1000	Date	SEPTEMBER 2021
		Frame Dimensions mm	(A1) 791 x 544
Drawn	SNC	Checked	JR
		Approved	MB

London
Kent
Derbyshire
Manchester
Stirling

IDOM

Cromford Mills, Mill Lane, Matlock, Derbyshire DE4 3RG
t: +44(0)1773 823 988 e: info.derbyshire@idom.com