

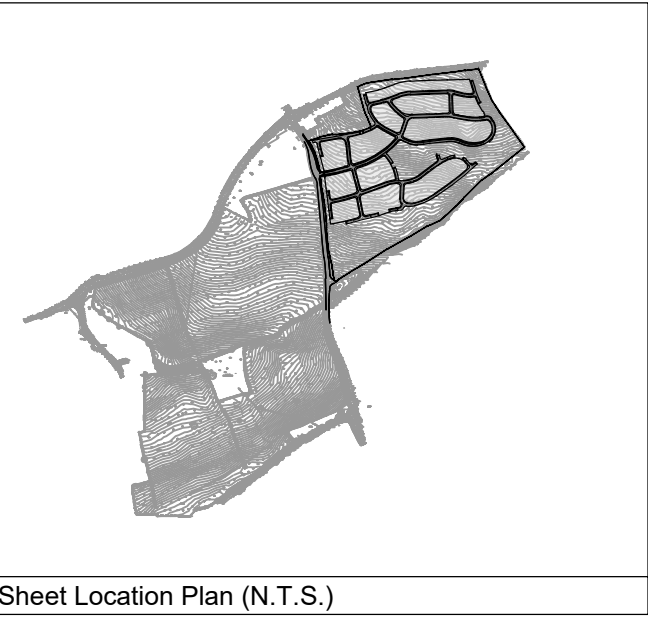

- LEGEND**
- DEVELOPMENT SITE BOUNDARY
  - - - EXISTING GAS MAIN
  - PROPOSED GAS SERVICES CONSTRUCTED AS PART OF SPINE ROAD
  - - - POTENTIAL FUTURE SERVICES DISTRIBUTION
  - PROPOSED GAS GOVERNOR KIOSK

- NOTES:**
1. ALL INFORMATION IS FOR ILLUSTRATION PURPOSES ONLY.
  2. OFF SITE REINFORCEMENT REQUIREMENTS TO BE CONFIRMED.
  3. SERVICES AVAILABLE LOCALLY/CONNECTIONS IN BOLSOVER ROAD TO BE CONFIRMED.
  4. DEVELOPMENT LOADINGS ARE TO BE CONFIRMED.
  5. SERVICES DISTRIBUTION SIZES/CAPACITY TO BE CONFIRMED.
  6. GAS GOVERNOR KIOSK LOCATION AND SIZES TO BE CONFIRMED.

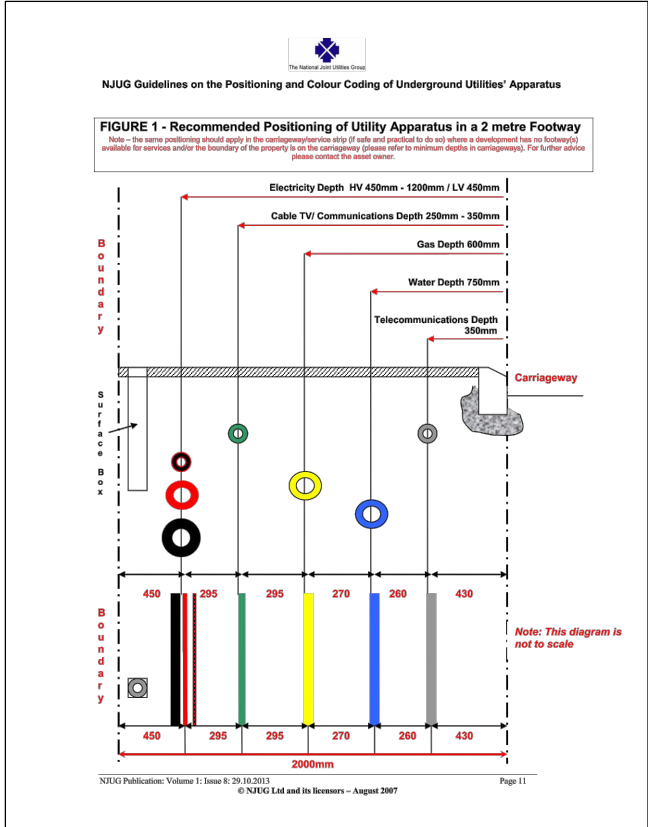

MASTER PLAN UPDATED	22-09-2021	P03
	BMS MB MB	
DRAWING AMENDED TO SUIT CLIENT COMMENTS	20-09-2021	P02
	SNC MB MB	
DRAWING AMENDED TO SUIT CLIENT COMMENTS	17-09-2021	P01
	SNC MB MB	
FIRST ISSUE	09-09-2021	P0
	SNC JR MB	
Issue Details	Dwn Chd App'd	
Client	PRELIMINARY	

DEVONSHIRE PROPERTIES

MASTIN MOOR

PROPOSED  
GAS LAYOUT PLAN  
PHASE 1 & 2

Dwg No.	22188-IML-00-XX-DR-C-0503	Revision	P03
Scale	1:1000	Date	SEPTEMBER 2021
Drawn	SNC	Checked	JR
		Approved	MB

London  
Kent  
Derbyshire  
Manchester  
Stirling

**IDOM**

Cromford Mills, Mill Lane, Matlock, Derbyshire DE4 3RQ  
t: +44(0)1773 823 988 e: info.derbyshire@idom.com

SCALE 1:1000

